



SORA

WALL LIGHT

Designed by Oliver Höglund & Ryan Roberts



TECHNICAL DATA

Application	Interior Use (Optional: Outdoor Use) Low Voltage (under 12v)	Input Power	100-240V AC
Glass	Bubbles / Clear	Output Power	4V DC Driver (350mA Constant Current) Supplied with Remote Driver
Wall Plate Finish	Matte Black / Matte White / Brass Finish Steel Finish / Bronze	Dedicated LED	1W - 350mA (Standard) / 2W (additional cost) Lifespan - 60,000+ Hours CRI>90
Dimensions	Glass: 110 x 110mm Mounting Plate: 110 x 15mm Protudes: 125mm	Lumen Output	150lm (1W) (Standard) / 300lm (2W)
Weight	0.5kg	Colour Temperature	2700K / 3000K (Standard) / 4000K
IP Rating	IP20 Indoor (Optional: IP55 Outdoor)	Dimming	Single-Use-1W LED Non-Dimmable (Standard) Optional: Single-use - 2W LED Triac Dimmable DALI Dimmable (additional cost) Please contact for alternative dimming options
Warranty	24 Months / 2 Years	Mounting	Integral Wall Bracket
Certification	CE / AS/NZS - 60598.2.1		

DIMENSIONS

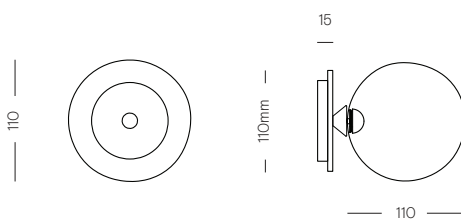

MOUNTING

Installation instructions

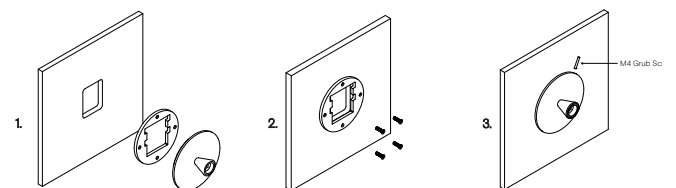

1. Unscrew the grub screw to separate the screw plate from the circular face plate. Prep the wall with a hole to match the cutout in the screw plate.

2. Install the screw plate to the wall using appropriate fasteners for the wall substrate. Secure the transformer into the wall cavity and feed the cable through the hole into the room. Connect the single electrified cable to the transformer.

3. Fit the circular wall plate over the mounting plate and secure with the supplied M4 grub screw at the top of this plate.

*The transformer needs to be accessible for maintenance purposes.