



SORA

SINGLE ROD - PENDANT

Designed and Handmade by Oliver Höglund & Ryan Roberts

Featuring an enchanting hand-blown glass shade, the Sora pendant light offers a selection between clear or captivating bubble glass finishes, resulting in a stunning soft illumination that establishes an ideal centerpiece either individually or in clusters above stairwells, dining tables, and within bathrooms. The bubble glass finish casts a distinctive shadow pattern along your space's walls, introducing a captivating burst of champagne-like effervescence. This feature piece is suspended by a sleek rod available in finishes of natural brass, matte black, medium bronze, or steel finish. Choose between warm, warm white, or white LED temperatures to set your desired ambiance. Meticulously hand-blown using premium Swedish clear glass, each glass shade carries the distinctiveness of SOKTAS Glass designs, promising an unparalleled and personalised lighting masterpiece that adds both elegance and character to your space.

Hand-Blown in Currumbin, Australia



TECHNICAL DATA

Application	Interior Use Only	Input Power	100 - 240VAC
Glass Colour	Clear	Output Power	4V DC Driver (350mA Constant Current) Supplied with Remote Driver
Rod Finish	Natural Brass / Matte Black / Matte White / Steel Finish / Medium Bronze Powdercoat	Dedicated LED	1W - 350mA (Standard) / 2W (additional cost) Lifespan - 60,000+ Hours CRI>90
Dimensions	Glass: 120 x 120mm Rod: Standard 1200mm (Optional: Custom length)	Lumen Output	150lm (1W) (Standard) / 300lm (2W)
Ceiling Mount	Ø 110mm	Colour Temperature	2700K / 3000K (Standard) / 4000K
Weight	1.5kg	Dimming	Single-Use-1W LED Non-Dimmable (Standard) Optional: Single-use - 2W LED Triac Dimmable DALI Dimmable (additional cost) Please contact for alternative dimming options
Warranty	24 Months / 2 Years		
Certification	CE / AS/NZS - 60598.2.1		

DIMENSIONS

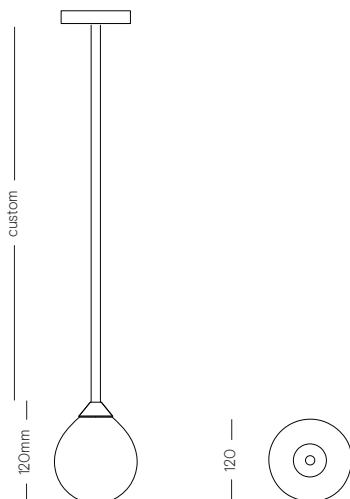

MOUNTING

Installation Instructions

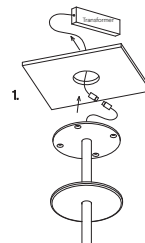

Prep the ceiling with an approx. 50mm hole to fit the transformer. Place the transformer in the ceiling and feed the cable through the hole into the room. Connect the single electrified cable to the transformer.

*The transformer needs to be accessible for maintenance purposes.

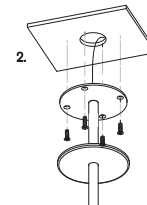

Screw the steel mounting plate to the ceiling using appropriate fasteners for the ceiling substrate.

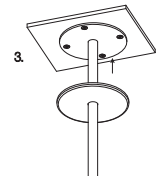

Secure the magnetic cover plate onto the mounting plate.