



CORAL

TRIO PENDANT - OFF CENTERED

Designed and Handmade by Oliver Höglund & Ryan Roberts

Elevate your space with the Coral Trio pendant light, a captivating modern centrepiece perfect for entryways, bathrooms, and kitchen islands. Three exquisite glass-blown discs are elegantly suspended from a rod, available in a selection of finishes including brass finish, steel finish, matte black, matte white, or medium bronze powder coating. Available in a centred or off-centred installation, opt for frosted or clear glass to match your style and set the mood with a choice of warm, warm white, or white LED temperatures. Meticulously hand-blown using premium Swedish clear glass, each disc carries the distinctiveness of SOKTAS Glass designs, promising an unparalleled and personalised lighting masterpiece that adds both elegance and character to your space.

Hand Made in Currumbin, Australia.



TECHNICAL DATA

Application	Interior & Outdoor Use	Input Power	100 - 240VAC
Glass Colour	Frosted / Clear	Output Voltage Standard	12V DC Driver (350mA Constant Current) Supplied with Remote Driver
Suspension Rod	Brass Finish / Matte Black / Matte White / Steel Finish / Medium Bronze Powdercoat	Dedicated LED	3 x 1W - 350mA (Standard) 3 x 2W - 350mA (additional cost) Lifespan - 60,000+ Hours CRI>90
Glass Diameter	Small: 120 - 140mm Medium: 150 - 170mm Large: 200 - 220mm	Colour Temperature	2700K / 3000K (Standard) / 4000K
Rod Length	1200mm (Standard) (custom lengths available)	Dimming	Yes - Dimmable TRIAC/Phase (Standard) Dimmable DALI (additional cost) Please contact for alternative dimming
Glass Orientation	180 Degree Around the Rod 360 Degree Around the Rod	Warranty	24 Months / 2 Years
Certification	AU/NZ AS/NZS 60598.1, 60598.2.1 EU EN 60598.1, 60598.2.1 US/CAN ETL/UL 1598, CSA C22.2#250.0	IP Rating	IP44

DIMENSIONS

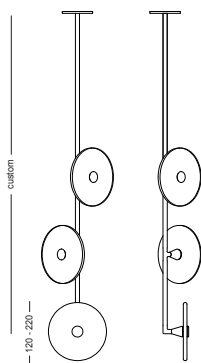

Glass Installation

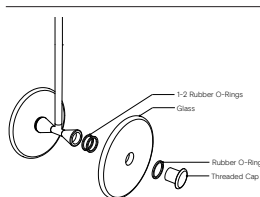

To install the glass piece, hold the glass against the LED housing and thread the 50mm threaded cap into the LED housing.

*Ensure the rubber o-rings are installed in the correct position, 1 behind the glass, and 1 in-front on the glass. If the glass is not held firmly when the threaded cap is fully screwed in, install an extra o-ring.

MOUNTING

Installation Instructions

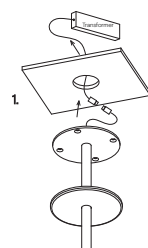

Prep the ceiling with an approx. 50mm hole to fit the transformer. Place the transformer in the ceiling and feed the cable through the hole into the room. Connect the single electrified cable to the transformer.

*The transformer needs to be accessible for maintenance purposes.

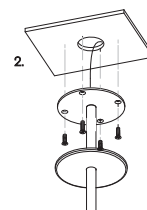

Screw the steel mounting plate to the ceiling using appropriate fasteners for the ceiling substrate.

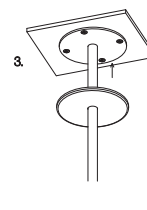

Secure the magnetic cover plate onto the mounting plate.