



## CORAL DOME WALL LIGHT

Designed and Handmade by Oliver Höglund & Ryan Roberts

Illuminate your space with the Coral Dome wall light, a sophisticated clear glass-blown fixture designed to elevate entryways, hallways, and kitchen spaces. The incorporation of the sleek dome back makes this piece a modern feature point. Tailor it to your preferences by selecting a dome finish of matte black, brass finish, matte white or medium bronze, and set the mood of your space with a choice of warm, warm white, or white LED temperatures. Meticulously hand-blown using premium Swedish clear glass, each disc carries the distinctiveness of SOKTAS Glass designs, promising an unparalleled and personalised lighting masterpiece that adds both elegance and character to your space.

Hand Made in Currumbin, Australia.



### TECHNICAL DATA

Application	Interior & Outdoor Use	Input Power	100-240V AC
Glass	Frosted / Clear	Output Power	4V DC Driver (350mA Constant Current) Supplied with Remote Driver
Steel Dome Finish	Matt White / Matte White / Brass Finish Steel Finish / Medium Bronze Powdercoat	Dedicated LED	1W - 350mA (Standard) / 2W (additional cost) Lifespan - 60,000+ Hours CRI>90
Glass Dimensions	160mm Glass Thickness: 10-20mm	Colour Temperature	2700K / 3000K (Standard)
Wall Mount (Dome):	260mm Protrudes: 50mm	Dimming	Triac-Dimmable (Standard) Optional: DALI (additional cost) Please contact for alternative dimming options
IP Rating	IP65	Mounting	Integral Wall Bracket
Warranty	24 Months / 2 Years		
Certification	AU/NZ AS/NZS 60598.1, 60598.2.1 EU EN 60598.1, 60598.2.1 US/CAN ETL/UL 1598, CSA C22.2#250.0		

### DIMENSIONS

### MOUNTING

#### Glass Installation

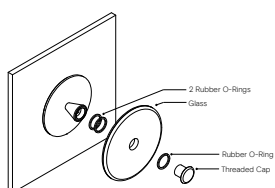

To install the glass piece, hold the glass against the LED housing and thread the 30mm threaded cap into the LED housing.

\*Ensure the rubber o-rings are installed in the correct position, with 2 behind the glass, and 1 in front on the glass. If the glass is not held firmly when the threaded cap is fully screwed in, install an extra o-ring in front of the glass.

#### Wall Plate Dimensions

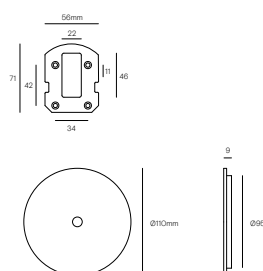

#### Installation Instructions

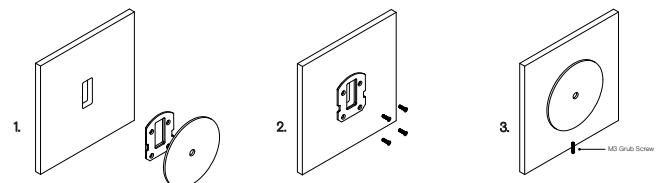

Prep the wall with an hole match the wall plate cutout. Secure the transformer into the wall cavity and feed the cable through the hole into the room. Connect the single electrified cable to the transformer.

\*The transformer needs to be accessible for maintenance purposes.

Screw the mounting plate to the wall using appropriate fasteners for the wall substrate.

Fit the circular wall plate over the mounting plate and secure with the supplied M3 grub screw at the bottom of the plate.